

BOOMER 14 TRACK 230V (Ad. Bin. Trifase Nero o Bianco)

341BA01H11
341BA02H11

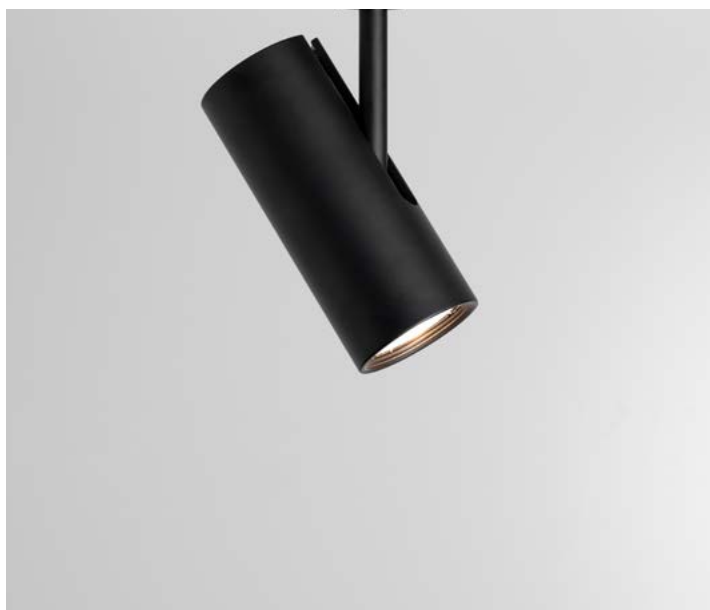

Descrizione del prodotto / Product description

Proiettore LED da interno con fissaggio a plafone.

Ideale per l'illuminazione d'accento.

Corpo realizzato da tornitura di alluminio con trattamento superficiale di verniciatura o galvanica rame.

Disponibili varie ottiche e schermo in PMMA trasparente serigrafato.

Sorgente COB LED ad alta resa.

Fornito con adattatore per binari a 230Vac.

LED projector for indoor with ceiling box system.

Ideal for accent light.

Body made of turning aluminum with painted or copper finish.

Various available spot optics and silk-screened screen made of clear PMMA.

COB LED source with ON/OFF driver on-board.

Supplied with 230Vac track adapter.

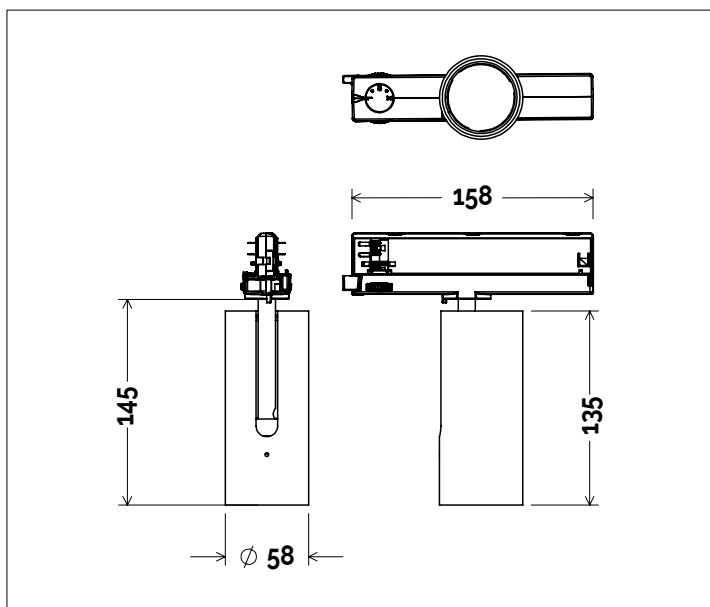

Dati tecnici | Technical Info

* su richiesta / on requests

Finiture Finishes	4001 Bianco White
	4002 Nero Black
	4010 Oro Gold
	4011 Bronzo Bronze
	Verniciati RAL RAL Paintings*
Potenza Power	14W
Corrente Current	-
Tensione Voltage	220/240Vac
Tolleranza cromatica Chromatic tolerance	3 SDCM
Flusso luminoso Luminous Flux	1500lm
Mantenimento del flusso luminoso Flux Maintenance	≥50.000h
Temperature di esercizio Operating temperature	-20° ~ 45°

Simbologia tecnica Technical informations

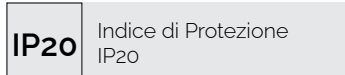
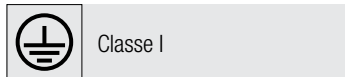
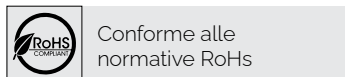
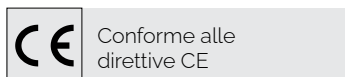

Temperatura di Colore Color Temperature

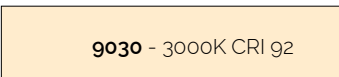
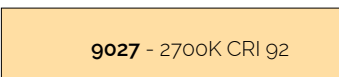

Ottiche Optics

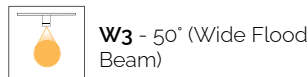

Sistemi di Controllo Control System

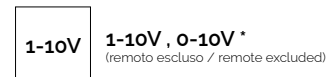

Creazione Codice | Code construction

341BA01H11 / 341BA02H11-XXXX-XX-XXXX

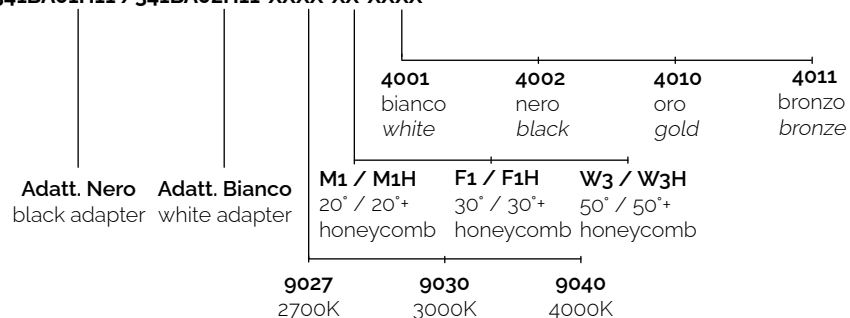

Dati Fotometrici | Photometric Specification

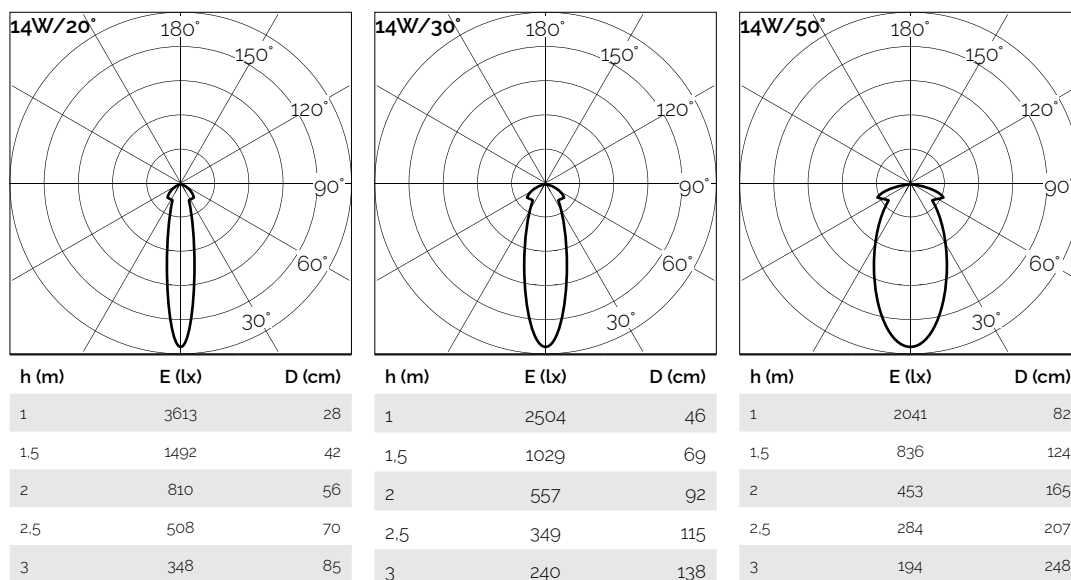

Accessori | Accessories

Honeycomb / Honeycomb

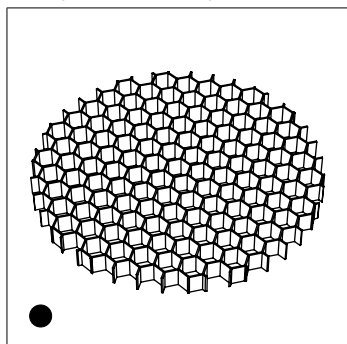

Filtro Alveolare anti-abbagliamento.
(spessore 3mm)

Anti-glare Honey Comb.
(thickness 3mm)